



Flat 4 10 Charles Street

St. Helier, JE2 4SF

Asking Price £210,000

 | bedroom

 | receptions

 | Bathrooms



14530259

12 The Parade, St Helier, JE2 3QP

Tel: 01534 888139 | Email: info@huelinhomes.com | www.huelinhomes.com

Located in the town centre, close to local shops and restaurants we have a one bedroom apartment. The property comprises of a double bedroom with fitted wardrobes, shower room, spacious living room and a separate fully fitted kitchen. This apartment would make an ideal investment or first step on to the property ladder.

Lounge / Diner

9'9" x 14'9" (2.97m x 4.50m)

Bright lounge/diner.

Kitchen

6'8" x 5'11" (2.03m x 1.80m)

Fully fitted kitchen.

Bedroom

11'8" x 9'6" (3.56m x 2.90m)

Double bedroom with fitted wardrobes.

Shower Room

4'9" x 5'10" (1.45m x 1.78m)

Bathroom fitted with a matching three piece suite comprising of shower cubicle, wash hand basin and low level coupled WC.

Services

All mains. Mains Drains. Gas central heating. Fully double glazed throughout.

Service Charges

The service charges for the property are £90.30 pcm which includes parish rates, cleaning, repairs and maintenance, building insurance and water rates.

Additional Information

The exterior of the building has been redecorated recently.

Tenure

Share Transfer.

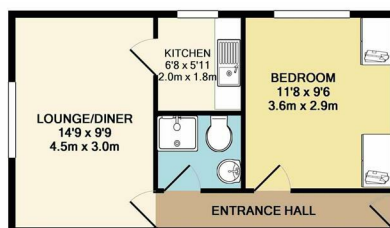

TOTAL APPROX. FLOOR AREA 381 SQ.FT. (35.4 SQ.M.)

Whilst every attempt has been made to ensure the accuracy of the floor plan contained here, measurements of doors, windows, rooms and any other items are approximate and no responsibility is taken for any error, omission, or mis-statement. This plan is for illustrative purposes only and should be used as such by any prospective purchaser. The services, systems and appliances shown have not been tested and no guarantee

Please note we have not tested any apparatus, fixtures, fittings, or services. Interested parties must undertake their own investigation into the working order of these items. All measurements are approximate and photographs provided for guidance only.